

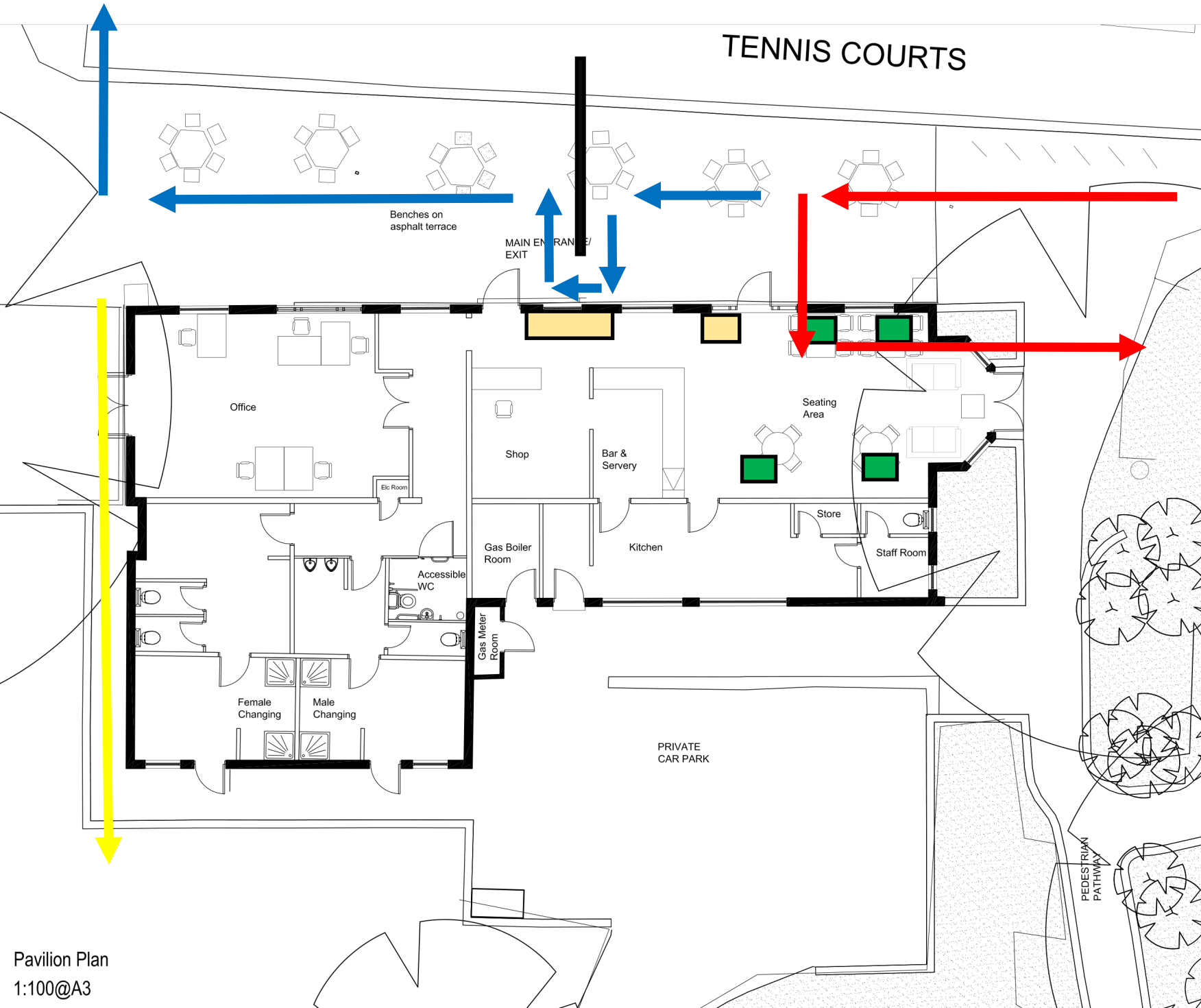

TENNIS COURTS





Do not scale from this drawing, except for town planning purposes.
 Work to figured dimensions only.
 This drawing is the property of Christopher Dudley and copyright is reserved by him.
 This drawing is issued on condition that it is not copied, used or disclosed by or to any unauthorised person without the prior written consent of Christopher Dudley.
 The areas on this drawing have been measured directly from a CAD drawing and have no tolerances added or subtracted.
 The areas have been calculated in accordance with the Code of Measuring Practice, 8th Edition (2007) using the latest options N/A, G/A, S/GA. They are approximate and relate to the built area of the building at the current state of the design. Any decisions to be made on the basis of these predictions, whether as to project viability, pre-letting, lease agreements and the like, should make allowance for the following:
 - Design development
 - Accurate site survey, site levels and dimensions need to be fully evaluated
 - Allowance for construction methods and building tolerances.
 - Local authority constraints.
 rev date dwn by chd description
 / 08.02.15 CD CD FIRST ISSUE

**CATERING
 ROUTE**

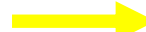
**SPORTS
 ENTRANCE**

**SPORTS
 EXIT**

**COVID CHECK
 IN DESK**

ACTIVE SEATING

Client	The Royal Parks		
status	FOR PLANNING		
project	Regent's Park Tennis Facilities - Refurbishment York Bridge, London, NW1 5BL		
title	Pavilion Layout As Existing		
scale	1:100@A3	date	31/10/16
drawn	DG	checked	
drawing no.	RGT03-030-011	revision	A

Pavilion Plan
 1:100@A3